

4 CORNER TABLE

RYAN MCNITT
FURNITURE DESIGN
ID 2793



MICHAEL P. JOHNSON - THE BRADLEY RESIDENCE - SCOTTSDALE, ARIZONA 2007

FRONT ELEVATION

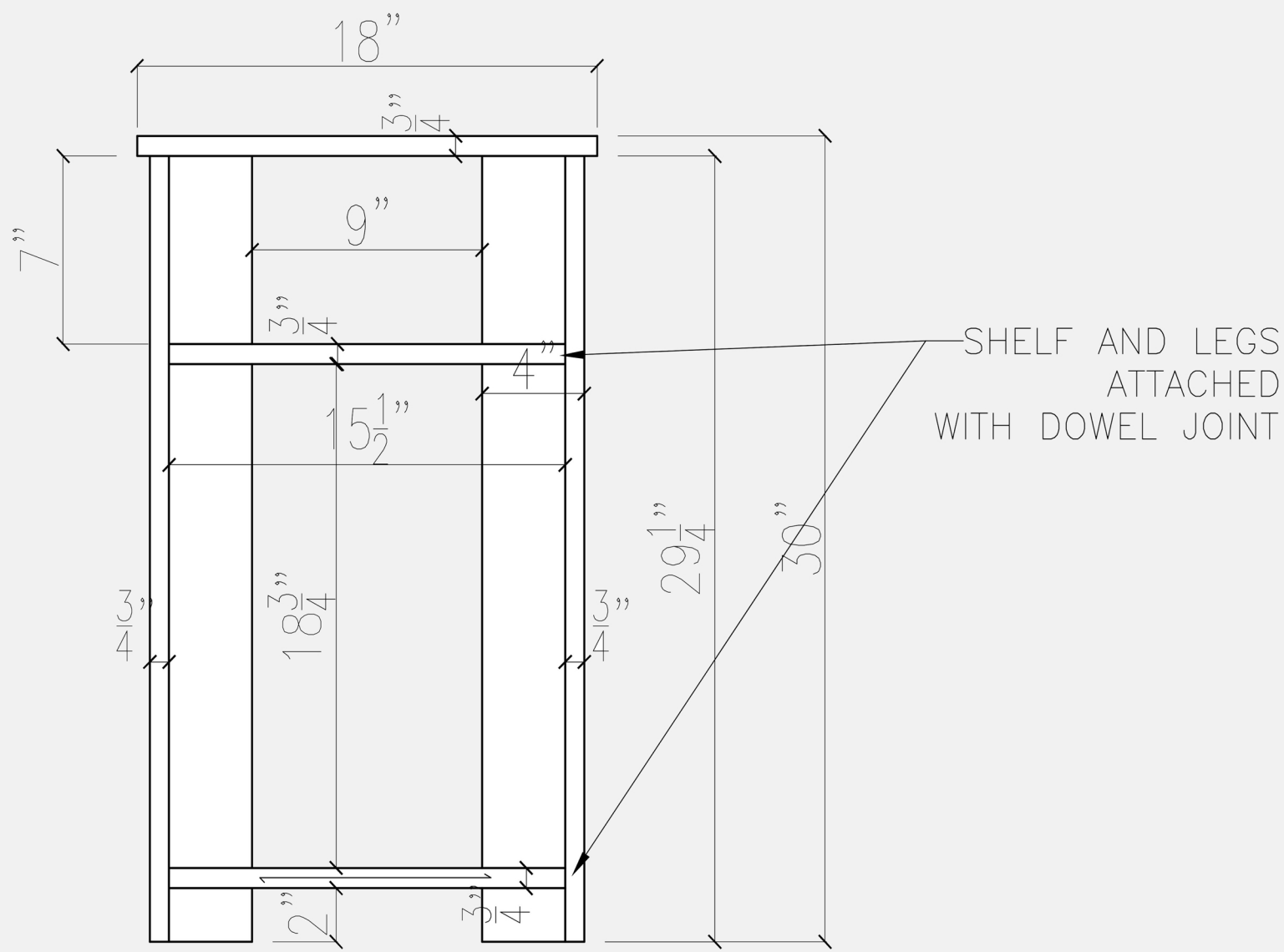

SIDE ELEVATION

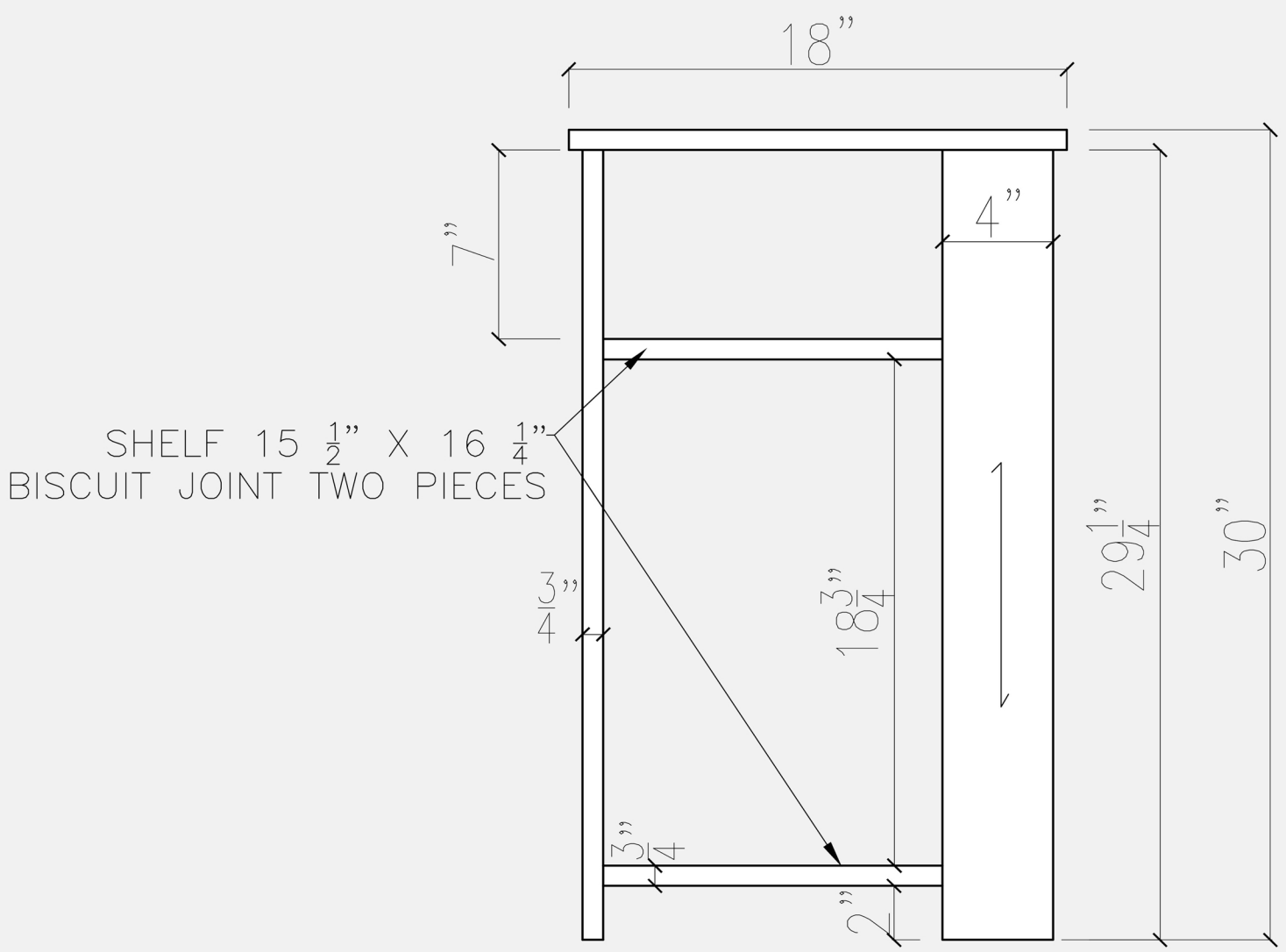

EXPLODED AXONOMETRIC

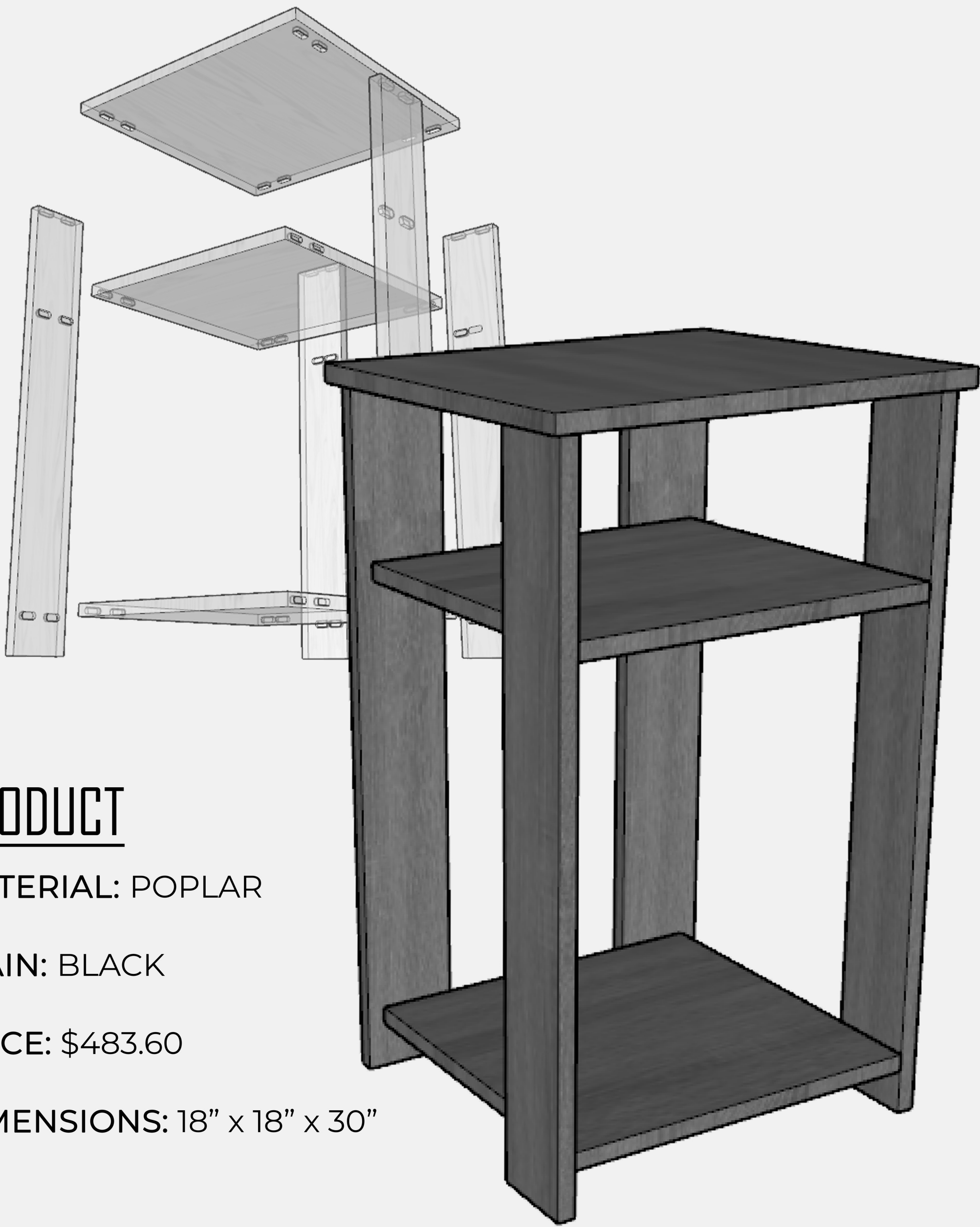

PRODUCT

MATERIAL: POPLAR

STAIN: BLACK

PRICE: \$483.60

DIMENSIONS: 18" x 18" x 30"

CONCEPT APPLICATION

The Bradley Residence by Michael P. Johnson will influence the design of a full scale furniture piece, which will signify the importance of simplicity. The piece should primarily focus on functionality and consist of a design that does not distract viewers from its surroundings. Geometric forms will be heavily used to establish unity within the structure of the piece. Simplicity will be reflected by simple lines and a monochromatic color scheme. This creates an uncluttered design, which connects the importance of simplicity and functionality. Showcasing the aesthetic qualities of contemporary and modern design will ultimately support the piece and its influenced style. The name of the piece was derived from the simplicity of squares only having four corners. It also sybolizes the Four Corners of the United States, a region where Colorado, Utah, Arizona, and New Mexico intersect, creating a quadripoint. This area is significant because the majority of the architect's work is located in the Southwest, particularly Arizona.